

SC-74/SC-74A (Mini Mold)
 SC-95 (Mini Mold Thin Type)

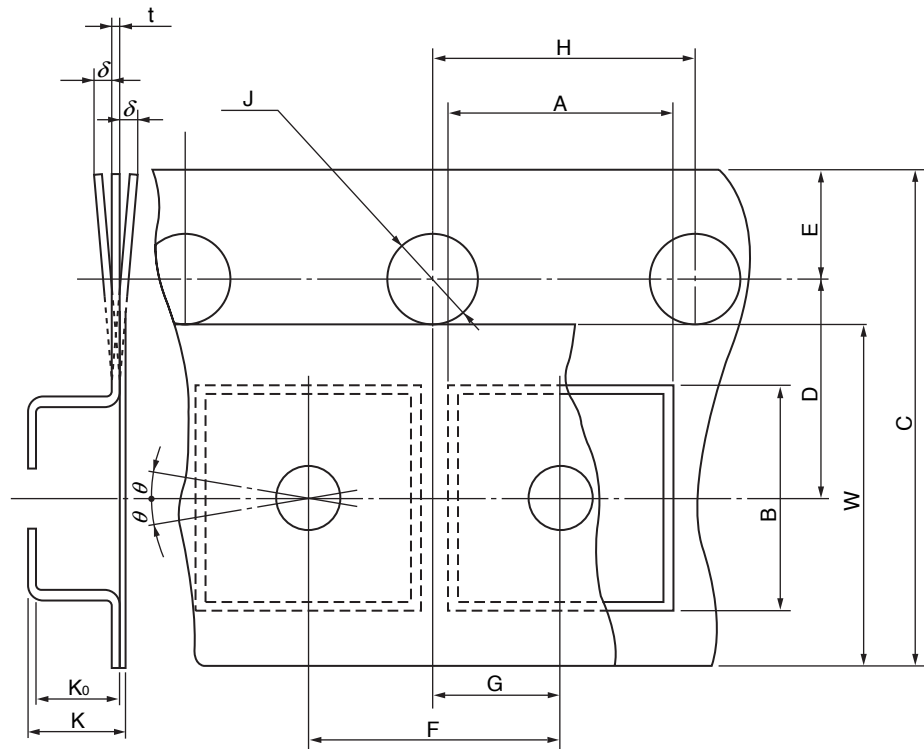

UNIT : mm

ITEM	SYMBOL	SIZE	REMARKS
Depression Angular Hole for Device Insertion	Length	A	3.18±0.1 Opening Size
	Width	B	3.40±0.1 Opening Size
	Depth	K ₀	1.4±0.1 Inner Space
	Pitch	F	4.0±0.1 Accumulative Tolerance $\begin{matrix} +0.1 \\ -0.3 \end{matrix}$ MAX./10 Pitch
Round Hole for Feeding	Diameter	J	$\phi 1.5 \begin{matrix} +0.1 \\ -0 \end{matrix}$
	Pitch	H	4.0±0.1 Accumulative Tolerance $\begin{matrix} +0.1 \\ -0.3 \end{matrix}$ MAX./10 Pitch
	Position	E	1.75±0.1
Distance Between Center-lines	Length Direction	G	2.0±0.05
	Width Direction	D	3.5±0.05
Cover Tape	Width	W	5.5 $\begin{matrix} +0.3 \\ -0 \end{matrix}$
Carrier Tape	Width	C	8.0±0.2 Warpage δ : 0.3 MAX.
	Thickness	t	0.3±0.05
Device	Tilt	θ	30° MAX.
Overall Thickness	K	1.75 MAX.	